

**GOVERNMENT OF INDIA
(MINISTRY OF RAILWAYS)
RESEARCH, DESIGNS & STANDARDS ORGANISATION
MANAK NAGAR, LUCKNOW-226 011**

No. EL/3.2.61

Dated : 09.12.1999

MODIFICATION SHEET NO. ELRS/MS/ 0274 (REV `O') -99

1.0 TITLE

Provision of Rain Shed on End Caps at either end of horizonfal insulator flange of Vacuum Circuit Breaker type 20CB of M/s. Alstom.

2.0 OBJECT

Cases of flashover between end caps and plate of vacuum circuit breaker type 20 CB of M/s. Alstom were reported by Railways. In order to avoid flashovers, it has been decided to provide Rain Shed on End Caps on either end of the horizontal insulator flange. This will improve the insulation between the end caps and base plate of VCB i.e. between high voltage (25 KV) and earth.

3.0 WORK TO BE CARRIED OUT

Provide Rain Shed on End Cap of Heriene H521 EPDM rubber on either end of horizontal insulator flange.

4.0 APPLICATION

All electric locomotives & EMUs fitted with VCBs type 20CB of M/s. Alstom.

5.0 MATERIAL REQUIRED

Two Nos. Rain Shed for End Cap for each VCB. The End caps can be procured from M/s. Alstom, Naini.

6.0 MATERIAL RENDERED SURPLUS

Nil.

7.0 REFERENCE

MoM held on VCB on 22.4.99 at Naini Works, Allahabad.

8.0 MODIFICATION DRAWING

RDSO Drawing No. SKEL 4545

9.0 AGENCY FOR IMPLEMENTATION

- (a) All electric loco sheds / EMU Car Sheds during scheduled inspection / AOH / IOH or whenever the VCB is received for any repair / attention.
- (b) POH shops during POH.
- (c) M/s. Alstom, Naini on new supplies.

10.0 DISTRIBUTION

As per enclosed list.



(Arun Srivastava)
for Director General (Elect.)

Encl: RDSO Drg. No. SKEL – 4545

Dt.	12.12.99
D	—
C	—
Rev	—

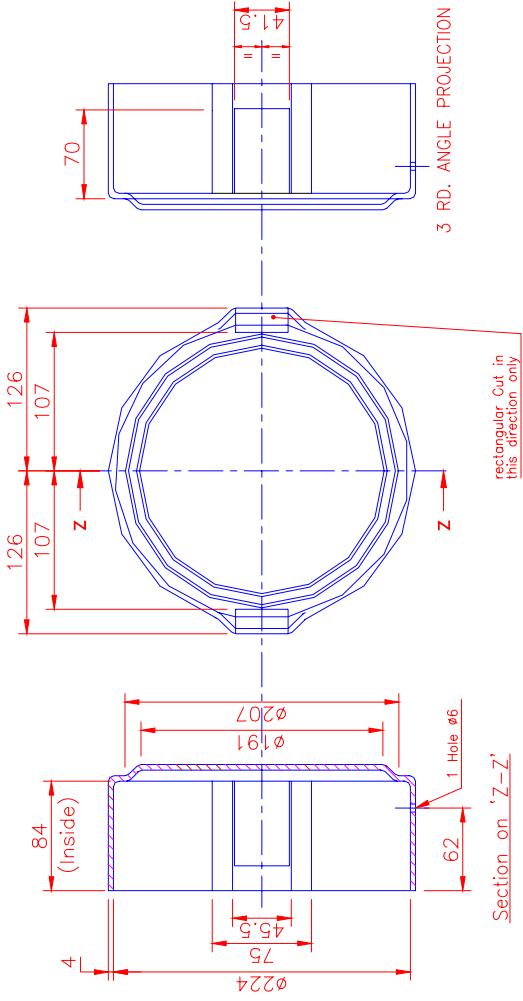

Material: High voltage insulation
Colour: Grey
Application: Herlene H521 EPDM
(to insulate 25kv from earth)

ALL DIMENSION IN mm.

REF. NO.	PART NO.	DESCRIPTION	DETAIL DRG NO.	NO./LOCO	MATL.	SPEC.
REF:--	ALSTOM DRG NO. LSC:278	SCALE: NTS	APPROVED	Sd.		
RAIN SHED FOR END CAP VCB TYPE 20CB			FIRST ISSUED	SUPERSEDS		
RDSO. ELEC. DTE. SKEL-4545			SUPERSEDED BY:--			

STATUS	ALT.	REF NO.	DESCRIPTION	APPD. BY	DATE
--------	------	---------	-------------	----------	------

